

Butler
LUZERNE

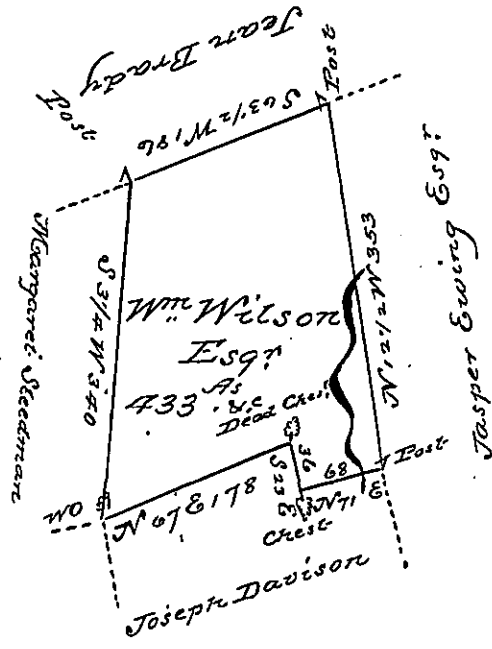

Draft of a tract of land called _____ Situate on the Water of Nescopeck Creek in the County of Luzerne Containing four Hundred & thirty three Acres & Allowe Surveyed for William Wilson Esqr. the 28th day of Sept. 1793 by virtue of a Warrant dated the 13th day of June 1793

To

Daniel Brodhead Esqr }
 Suror. Genl. }

By
Wm Gray D.S.

IN TESTIMONY that the above is a copy of the original remaining on file in the Department of Internal Affairs of Pennsylvania, made conformably to an Act of Assembly approved the 16th day of February, 1833, I have hereunto set my Hand and caused the Seal of said Department to be affixed at Harrisburg, this fifth day of July 1898

James W. Letta
 Secretary Internal Affairs.